

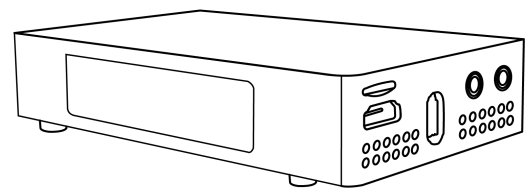

# Quick Start Guide

## 4K NDI Video Streaming Encoder/Decoder



Copyright 2023, Zowietek Electronics, Ltd. All rights reserved

NDI is a registered trademark of the Vizrt Group

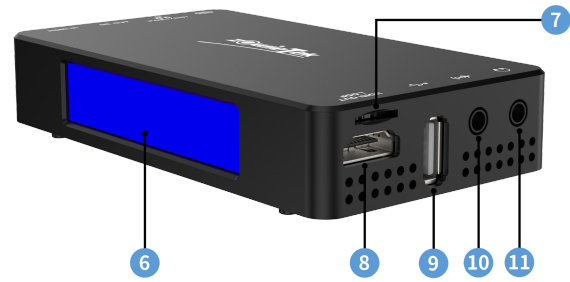

1	Tally	7	TF Card
2	USB TYPE C, Power Input Only	8	HDMI Out/Loop Out
3	LAN/PoE+/NDI@HX3	9	USB Port
4	DC Out*	10	Audio Input
5	HDMI In	11	Audio Output
6	LCD Screen		

**\* Note:**

It is forbidden to use the DC Out interface to supply power to ZowieBox. It may damage the ZowieBox. DO NOT remove DC Out Cap before reading the instruction manual.

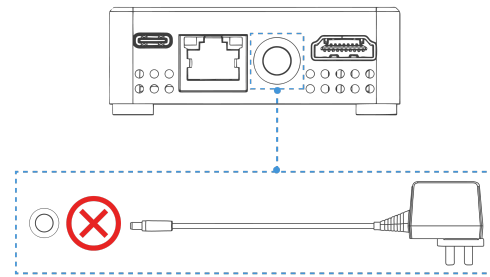

## 1. Packing List

Item	Unit	Quantity
4K NDI@Video Streaming Encoder/ Decoder	PCS	1
USB TYPE C Power Adapter	PCS	1
USB-C Cable	PCS	1
Cold Shoe	PCS	1
Quick Start Guide	PCS	1

## 2. Device Interface Description



## 3. LCD Screen Information

ZowieBox alternately displays the status and system information in two screens.

### The First Screen

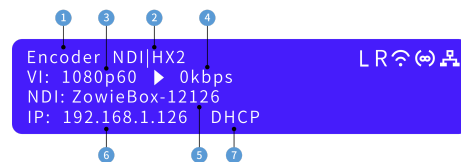

### The Second Screen

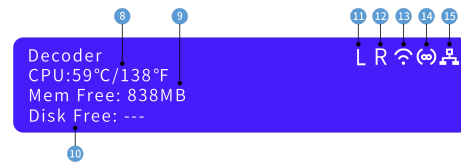

1	Working Mode	9	Memory Free
2	NDI Format/ Stream Format	10	Disk Free
3	Input/ Output Resolution	11	Loop Out
4	Encoder/ Decoder Bitrate	12	Tally Color
5	NDI Name/ Stream Name	13	WiFi Status
6	IP Address	14	Hotspot Status
7	DHCP Status	15	LAN Status
8	CPU Temperature		

## 4. Device Installation and Connection

### 4.1 Device Installation

Make sure the phone, PC or iPad is on the same LAN or WIFI as the ZowieBox.

#### 1) Connect Video Signal

Connect the HDMI signal from a video source (such as a camera) to the HDMI input port of the ZowieBox through a HDMI cable. Video formats and resolutions can be automatically detected by ZowieBox.

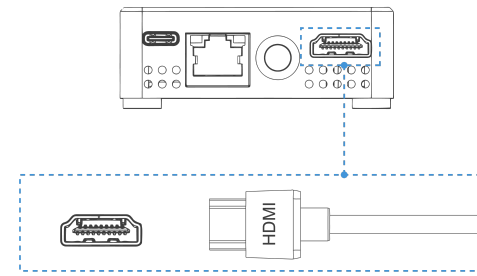

#### 2) Connect Network

Use a LAN cable to connect ZowieBox to a network port of network switch or network router with DHCP.

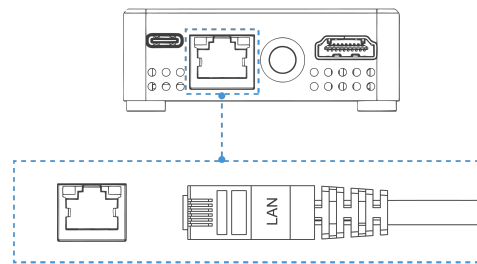

#### 3) Connect Power Supply

##### (1) USB-C

Use a LAN cable to connect ZowieBox to a network port of network switch or network router with DHCP.

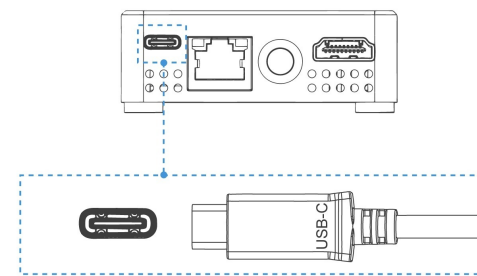

##### (2) PoE

ZowieBox can also be powered by Power over Ethernet (PoE/ PoE+). You needn't prepare a power adapter. To take advantage of PoE, the LAN cable has to be connected to a PoE Network Switch, but at least a CAT5e LAN cable is required for PoE.

### 4.2 Device Management

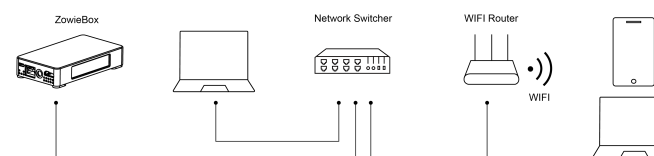

#### 1) Login the Web Console

ZowieBox provides five easy, quick ways to login into the Web console.

#### (1) IP Address

The ZowieBox's DHCP is turned on by default, so just find the IP address on the first screen 6 and type IP into the browser.

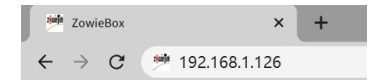

#### (2) Login ZowieBox by mDNS

Please enter http://ZowieBox-xxxxx.local in the browser of your computer or mobile phone. (mDNS URL is on the bottom of the ZowieBox.)

**4K NDI Video Encoder/Decoder**  
 Model: ZowieBox P/N: 30621-102  
 Input: USB TYPE C 25W DC OUT: 12V 1A Max.  
 BZ4123812057  
 Hotspot(SSID): ZowieBox-12057 Password: 12345678  
 Hotspot IP Addr: 170.128.88.1  
 URL: http://ZowieBox-12057.local  
 Fail-safe IP Addr: 192.168.5.168  
 User Name: admin Password: admin

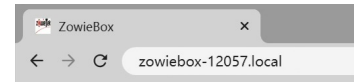

#### (3) Login ZowieBox by Hotspot

Direct connect to ZowieBox without a LAN or WIFI network. Connect the mobile device to ZowieBox's hotspot, it is default on. Please find its SSID and password at the bottom of ZowieBox. After connecting to the hotspot, enter http:// 170.128.88.1 in the browser to log into the Web console. When connecting to the hotspot, the phone may prompt that there is no Internet, which is normal, please continue to connect.

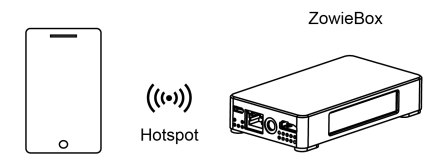

**4K NDI Video Encoder/Decoder**  
 Model: ZowieBox P/N: 30621-102  
 Input: USB TYPE C 25W DC OUT: 12V 1A Max.  
 BZ4123812057  
 Hotspot(SSID): ZowieBox-12057 Password: 12345678  
 Hotspot IP Addr: 170.128.88.1  
 URL: http://ZowieBox-12057.local  
 Fail-safe IP Addr: 192.168.5.168  
 User Name: admin Password: admin

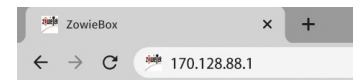

#### (4) Login ZowieBox by Device Discover

If you already own any ZowieBox or ZowiePTZ products, you can also log into a new device by Device Discover. Log in to the Web console, click "Setting > Dashboard" to use the discover function. After clicking the "Scan" button, find the device serial number on the bottom label corresponding to the new ZowieBox and click it to quickly jump to the device's Web console.

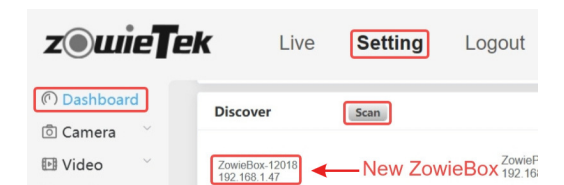

#### (5) Failsafe IP

When the connected network does not have the DHCP or directly connects ZowieBox to PC via LAN cable, or other unknown errors occur, the IP of ZowieBox will become a failsafe IP (192.168.5.168). Please add a 192.168.5.x address to the computer to log in to the Web console. Please refer to the user manual for detailed settings of the PC.

**Notes:**

Admin Login Username: admin; Password: admin

## 2) Control Device Switching

There are two ways, if the user needs to use a mobile phone to log in to the Web console after logging in the ZowieBox's Web from a computer.

- 1) Make sure the phone is on the same LAN as the ZowieBox, then scan the first QR code to log in to the mobile Web console.
- 2) Click the hotspot icon and scan the QR code that appears to connect to the hotspot. And make sure the phone is on the same hotspot as the ZowieBox. Then, scan the first QR code to log in to the mobile Web console.



## 5. Device Operation

### 5.1 Tally Indicator

The Tally on the ZowieBox can indicate the Tally working status when it is in the automatic mode. The indicator status as follows:

AUTO	NDI Encoder	Encoder	Decoder
Green	Preview (PWW)	/	/
Red	Program (PGM)	/	/
Blue	/	Push Streaming	Pull Streaming
White	/	No Push Streaming	No Pull Streaming

### Note:

When the mode of ZowieBox is NDI encoding mode and output to other NDI receivers, such as vMix, OBS, etc. ZowieBox will change the color of the tally light according to whether the receiver switches to program or preview.

### 5.2 Working Mode

ZowieBox has two working modes, encoder mode and decoder mode. ZowieBox supports resolutions up to 4K30. It also supports encoding or decoding RTSP, RTMP, SRT and NDI streams. Log into the Web console and click "Setting > System > Mode" to switch the working mode.

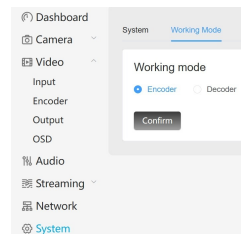

#### 1) General Encoder

When NDI is not turned on in encoder mode, it supports 4K30 input and output, and the bitrate can reach up to 50Mbps. It supports RTMP, RTSP and SRT internet streaming. Users can modify the encoding resolution and bitrate on the encoder page.

#### 2) NDI Encoder

After turning on NDI, ZowieBox supports 4K30 input and output, and the quality can reach up to HX3. Internet streaming is not supported in this working mode. Users can modify the encoding resolution and bitrate according to the input resolution on the encoder page and modify the NDI quality (HX/HX2/HX3) and NDI Device Name on the NDI page.

## 3) Decoder

In decoder mode, ZowieBox can decode RTSP, RTMP, NDI and SRT streams, and then output them.

### 5.3 NDI Connection

Compatible software:



ZowieBox is also compatible with other NewTek NDI-enabled encoding or stream media software. After ZowieBox switches to NDI encoding mode, the software that supports NDI can automatically discover it when it is on the same LAN. For example, directly select the ZowieBox that needs to be displayed on the screen in the NDI 5 tool.

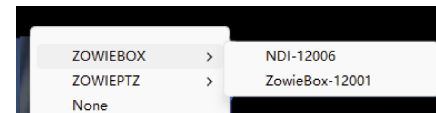

### Notes:

- a. Check whether the computer can log into the ZowieBox Web console.
- b. Please close the VPN and other related software.
- c. Please check whether the computer is using a private network or a public network, and check whether the all the NDI software is allowed to pass in "Allow an app through firewall".

### Firewall & network protection

Who and what can access your networks.

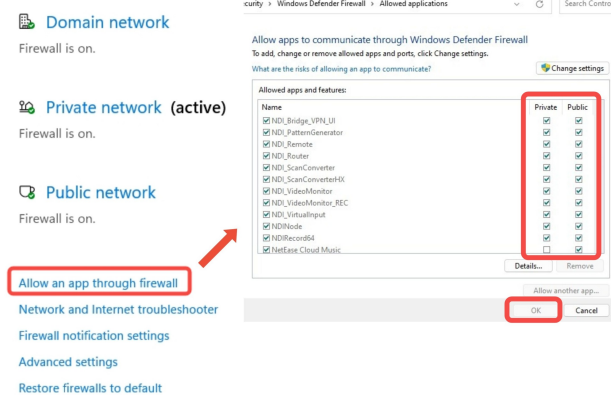

## 6. Local Stream

Through local stream, users can view the effect of encoder settings in real time on the same LAN.

- 1) Click "Streaming > Local" on the Web console.
- 2) Click the icon on the right to copy the URL of the main or sub stream.

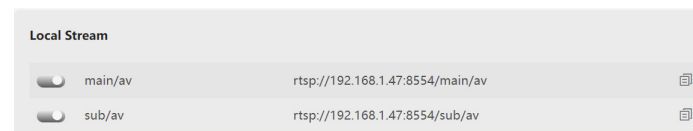

How to play the stream in VLC:

- 1) Click "Media > Open Network Stream", copy the URL into the text box and play it.
- 2) The playback resolution, bitrate, and frame rate are the same as those sets in the encoder page.

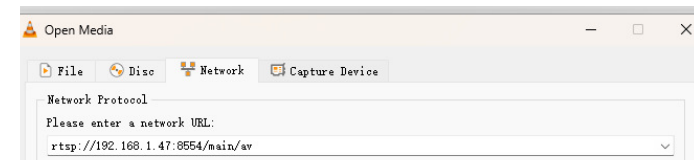

## 7. Internet Stream

- 1) On the Web console, click "Streaming > Live".
- 2) Click "+ Add" to create a new stream task.
- 3) Select the same protocol as the Stream URL and enter the Stream URL and Stream Key. If there is no Stream Key, skip it.
- 4) Input a proper alias name that will also show on the live preview page, then click "Save".
- 5) Turn on the Stream button to start streaming.

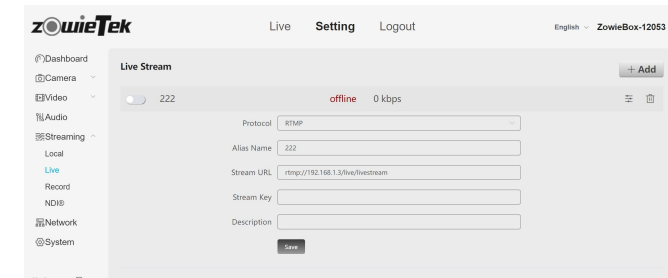

## 8. Restore Factory Setting and Reboot

- 1) Reboot ZowieBox: Click "System > Default > Reboot" on the Web console to reboot ZowieBox.
- 2) Restoring factory setting: Click "System > Default > Restore factory default settings" on the Web console.

### Notes:

- a. Restoring factory settings will reset all information except record, please choose carefully.
- b. The username and password of login will be "admin".

## 9. Restore Initial Password

After entering the wrong password five times, click to enter the ZowieBox reset page, and a dynamic verification code will appear on the LCD screen. After entering the verification code, the ZowieBox will be restored to factory settings. Then, the username and password will be both restored to "admin".

## 10. Firmware Upgrading

- 1) Click "System > Update" on the Web console.
- 2) Click "Choose file" to upload the correct firmware file.
- 3) Click "Upgrade" to start the upgrade.

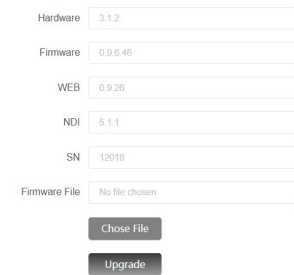

### Note:

After clicking upgrade, ZowieBox will automatically upgrade the firmware and restart, and the LCD screen will also prompt the upgrade information. Please do not perform any operations or disconnect the power before the restart is complete. It may take several minutes, please be patient.

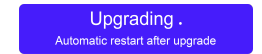

## 11. Warranty

4K NDI Video Streaming Encoder/Decoder with the highest-quality gives us the confidence to provide you with:

Hardware warranty for one year  
Software warranty for lifetime

For FAQs and more information, please visit:

<https://www.zowietek.com/knowledge-base/>

<https://www.zowietek.com/>

Or you can contact us:

[support@zowietek.com](mailto:support@zowietek.com)

A professional  
video camera, streaming, recording  
solution provider  
Since 2004

Zowietek Electronics, Ltd.  
2218 Hunan Road, West Wing 1701  
Pudong, Shanghai, China  
PN: 30621-10X